

# Fog nozzles

Fog nozzle head  
thread 10/24UNC/2A  
gr. 3  
oz. 0.1

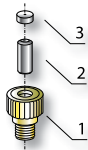

**Material:**  
1) Brass body  
2) Stainless steel cone  
3) Stainless steel orifice

Code	Flow rate
MT.151	15
MT.201	20
MT.301	30
MT.401	40

## Fog nozzle made of nicked brass

MT.NP10 gr. 3  
oz. 0.1

Nicked brass cap thread 10/24UNC/2A



## Fog nozzle made of stainless steel AISI 304

MT.NP10SS gr. 3  
oz. 0.1

Stainless steel AISI 304 cap thread 10/24UNC/2A



Fog nozzle head  
thread 10/24UNC/2A  
gr. 3  
oz. 0.1

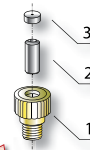

**Material:**  
1) Stainless steel body  
2) Stainless steel cone  
3) Stainless steel orifice



Code	Flow rate
MT.151SS	15
MT.201SS	20
MT.301SS	30
MT.401SS	40

Fog nozzle head - cleanable  
thread 10/24UNC/2A  
gr. 3  
oz. 0.1

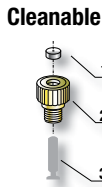

**Material:**  
1) Stainless steel orifice  
2) Nicked brass body  
3) Impeller plate

Code	Flow rate
MT.151C	15
MT.201C	20
MT.301C	30
MT.401C	40
MT.501C	50
MT.601C	60
MT.801C	80
MT.1001C	100

Fog nozzle with anti-drip check valve  
thread 10/24UNC/2A  
gr. 9  
oz. 0.3

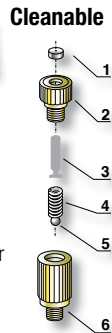

**Material:**  
1) Stainless steel orifice  
2) Nicked brass body  
3) Impeller plate  
4) Stainless steel spring  
5) Rubber ball seal  
6) Nicked brass adapter

Code	Flow rate
MT.154C	15
MT.204C	20
MT.304C	30
MT.404C	40
MT.504C	50
MT.604C	60
MT.804C	80
MT.1004C	100

Fog nozzle head - cleanable  
thread 10/24UNC/2A  
gr. 3  
oz. 0.1

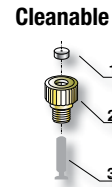

**Material:**  
1) Stainless steel orifice  
2) Stainless steel body  
3) Impeller plate

Code	Flow rate
MT.151SSC	15
MT.201SSC	20
MT.301SSC	30
MT.401SSC	40

Fog nozzle with anti-drip check valve  
thread 10/24UNC/2A  
gr. 9  
oz. 0.3

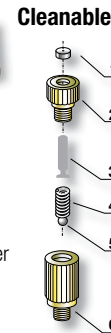

**Material:**  
1) Stainless steel orifice  
2) Stainless steel body  
3) Impeller plate  
4) Stainless steel spring  
5) Rubber ball seal  
6) Stainless steel adapter

Code	Flow rate
MT.154SSC	15
MT.204SSC	20
MT.304SSC	30
MT.404SSC	40

Fog nozzle with anti-drip check valve + filter  
thread 10/24UNC/2A  
gr. 12  
oz. 0.5

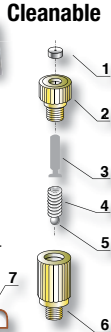
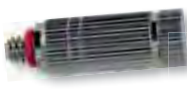

**Material:**  
1) Stainless steel orifice  
2) Nicked brass body  
3) Impeller plate  
4) Stainless steel spring  
5) Rubber ball seal  
6) Nicked brass adapter  
7) 25 microns filter

Code	Flow rate
MT.155LFC	15
MT.205LFC	20
MT.305LFC	30
MT.405LFC	40
MT.505LFC	50
MT.605LFC	60
MT.805LFC	80
MT.1005LFC	100

Fog nozzle with anti-drip check valve + filter  
thread 1/8" M  
gr. 13  
oz. 0.5

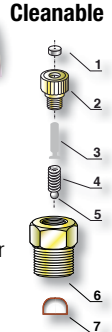

**Material:**  
1) Stainless steel orifice  
2) Nicked brass body  
3) Impeller plate  
4) Stainless steel spring  
5) Rubber ball seal  
6) Nicked brass adapter  
7) 60 microns filter

Code	Flow rate
MT.159LFC	15
MT.209LFC	20
MT.309LFC	30
MT.409LFC	40
MT.509LFC	50
MT.609LFC	60
MT.809LFC	80
MT.1009LFC	100

Fog nozzle with anti-drip check valve + filter  
thread 10/24UNC/2A  
gr. 12  
oz. 0.5

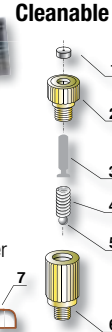
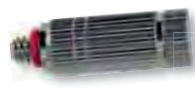

**Material:**  
1) Stainless steel orifice  
2) Stainless steel body  
3) Impeller plate  
4) Stainless steel spring  
5) Rubber ball seal  
6) Stainless steel adapter  
7) 25 microns filter

Code	Flow rate
MT.155LFSSC	15
MT.205LFSSC	20
MT.305LFSSC	30
MT.405LFSSC	40

Fog nozzle with anti-drip check valve + filter  
thread 1/8" M  
gr. 13  
oz. 0.5

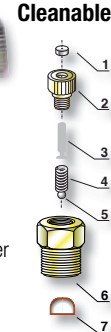

**Material:**  
1) Stainless steel orifice  
2) Stainless steel body  
3) Impeller plate  
4) Stainless steel spring  
5) Rubber ball seal  
6) Stainless steel adapter  
7) 60 microns filter

Code	Flow rate
MT.159LFSSC	15
MT.209LFSSC	20
MT.309LFSSC	30
MT.409LFSSC	40

# IDROBASE®

PASSION FOR WATER 



idrobaser®

[www.idrobaser.com](http://www.idrobaser.com)



perfectcool®

[www.perfectcool.it](http://www.perfectcool.it)



idrotech®

[www.idrotech.com](http://www.idrotech.com)



club dei riparatori®

[www.sparesclub.com](http://www.sparesclub.com)

35010 BORGORICCO (PD) ITALY -

Via dell'Industria, 25

Phone +39 049 9335903 - Fax +39 049 9335922

[idrobaser@idrobaser.com](mailto:idrobaser@idrobaser.com)

[www.idrobasergroup.com](http://www.idrobasergroup.com)

